

Modular Cooking Range Line EVO700 4-Hot Plates Electric Boiling Top Range

ITEM # _____

MODEL # _____

NAME # _____

SIS # _____

AIA # _____



372015 (Z7ECEH4R00)

4-hot plate (2,6 kW each)
electric boiling top

372127 (Z7ECEH4R0N)

4-hot plate (2,6 kW each)
electric boiling top

Short Form Specification

Item No. _____

To be installed on open base installations, bridging supports or cantilever systems. Four 2.6 kW cast-iron hot plates hermetically sealed to the one-piece top. Exterior panels in stainless steel with Scotch Brite finish. One piece pressed work top in 1.5 mm thick stainless steel. Right-angled side edges to allow flush-fitting junction between units.

Main Features

- Unit to be mounted on open base cupboards, bridging supports or cantilever systems.
- The four 2.6kW cast-iron plates are hermetically sealed to the one-piece top.CHAR(13)CHAR(10)
- The special design of the control knob system guarantees against water infiltration.
- IPx4 water protection.
- Suitable for countertop installation.

Construction

- All exterior panels in Stainless Steel with Scotch Brite finishing.
- One piece pressed 1.5 mm work top in Stainless steel.
- Model has right-angled side edges to allow flush fitting joints between units, eliminating gaps and possible dirt traps.

APPROVAL: _____

Optional Accessories

- | | | |
|--|------------|--------------------------|
| • Junction sealing kit (only for 372015) | PNC 206086 | <input type="checkbox"/> |
| • Support for bridge type installation, 800 mm (only for 372015) | PNC 206137 | <input type="checkbox"/> |
| • Support for bridge type installation, 1000 mm (only for 372015) | PNC 206138 | <input type="checkbox"/> |
| • Support for bridge type installation, 1200 mm (only for 372015) | PNC 206139 | <input type="checkbox"/> |
| • Support for bridge type installation, 1400 mm (only for 372015) | PNC 206140 | <input type="checkbox"/> |
| • Support for bridge type installation, 1600 mm (only for 372015) | PNC 206141 | <input type="checkbox"/> |
| • Frontal handrail 800 mm (only for 372015) | PNC 206167 | <input type="checkbox"/> |
| • Large handrail (portioning shelf) 800 mm (only for 372015) | PNC 206186 | <input type="checkbox"/> |
| • Frontal handrail 1200 mm (only for 372015) | PNC 206191 | <input type="checkbox"/> |
| • Frontal handrail 1600 mm (only for 372015) | PNC 206192 | <input type="checkbox"/> |
| • Right and left side handrails (only for 372015) | PNC 206240 | <input type="checkbox"/> |
| • Water column with swivel arm (water column extension not included) (only for 372015) | PNC 206289 | <input type="checkbox"/> |
| • Water column extension (only for 372015) | PNC 206291 | <input type="checkbox"/> |
| • Chimney upstand, 800 mm (only for 372015) | PNC 206304 | <input type="checkbox"/> |
| • 2 side covering panels, height 250 mm, depth 700 mm (only for 372015) | PNC 206320 | <input type="checkbox"/> |
| • Chimney grid net, 400mm (only for 372015) | PNC 206400 | <input type="checkbox"/> |

Modular Cooking Range Line

EVO700 4-Hot Plates Electric Boiling Top Range

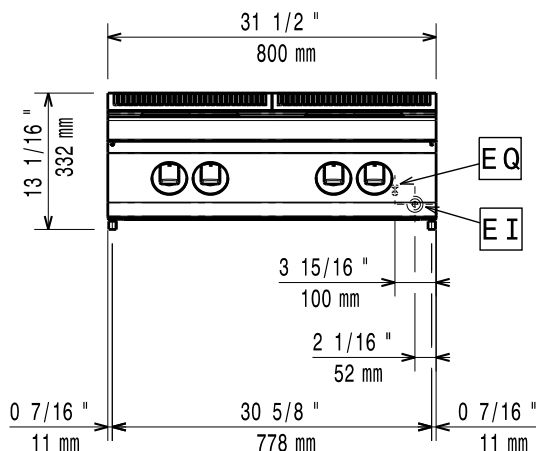
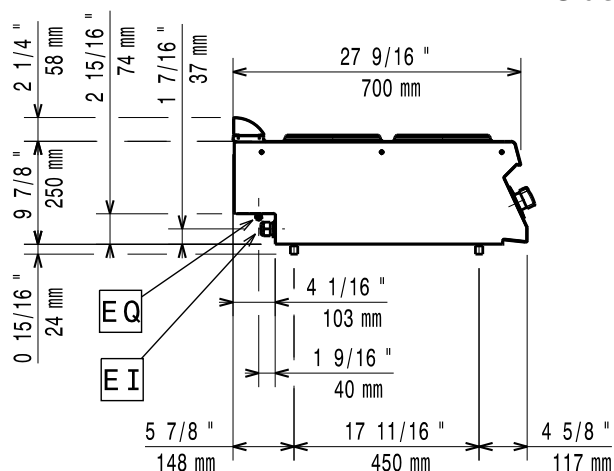
Front

Side

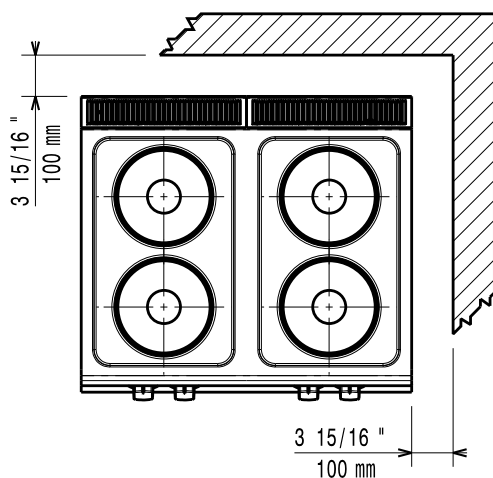
EI = Electrical inlet (power)
 EQ = Equipotential screw

Top

Electric

Supply voltage:

372015 (Z7ECEH4R00)

380-400 V/3 ph/50-60 Hz

372127 (Z7ECEH4R0N)

230 V/3 ph/50/60 Hz

Predisposed for:

Total Watts:

10.4 kW

Key Information:

Net weight:

40 kg

Shipping weight:

38 kg

Shipping height:

372015 (Z7ECEH4R00)

530 mm

372127 (Z7ECEH4R0N)

540 mm

Shipping width:

820 mm

Shipping depth:

860 mm

Shipping volume:

372015 (Z7ECEH4R00)

0.37 m³

372127 (Z7ECEH4R0N)

0.38 m³

[NOT TRANSLATED]

372015 (Z7ECEH4R00)

EH74T

372127 (Z7ECEH4R0N)

N7CE1

Front Plates Power:

2.6 - 2.6 kW

Back Plates Power:

2.6 - 2.6 kW

Front Plates dimensions:

Ø 230 Ø 230

Back Plates dimensions:

Ø 230 Ø 230

If appliance is set up or next to or against temperature sensitive furniture or similar, a safety gap of approximately 150 mm should be maintained or some form of heat insulation fitted.